

Guitar 3D - Pairing Fret Zealot

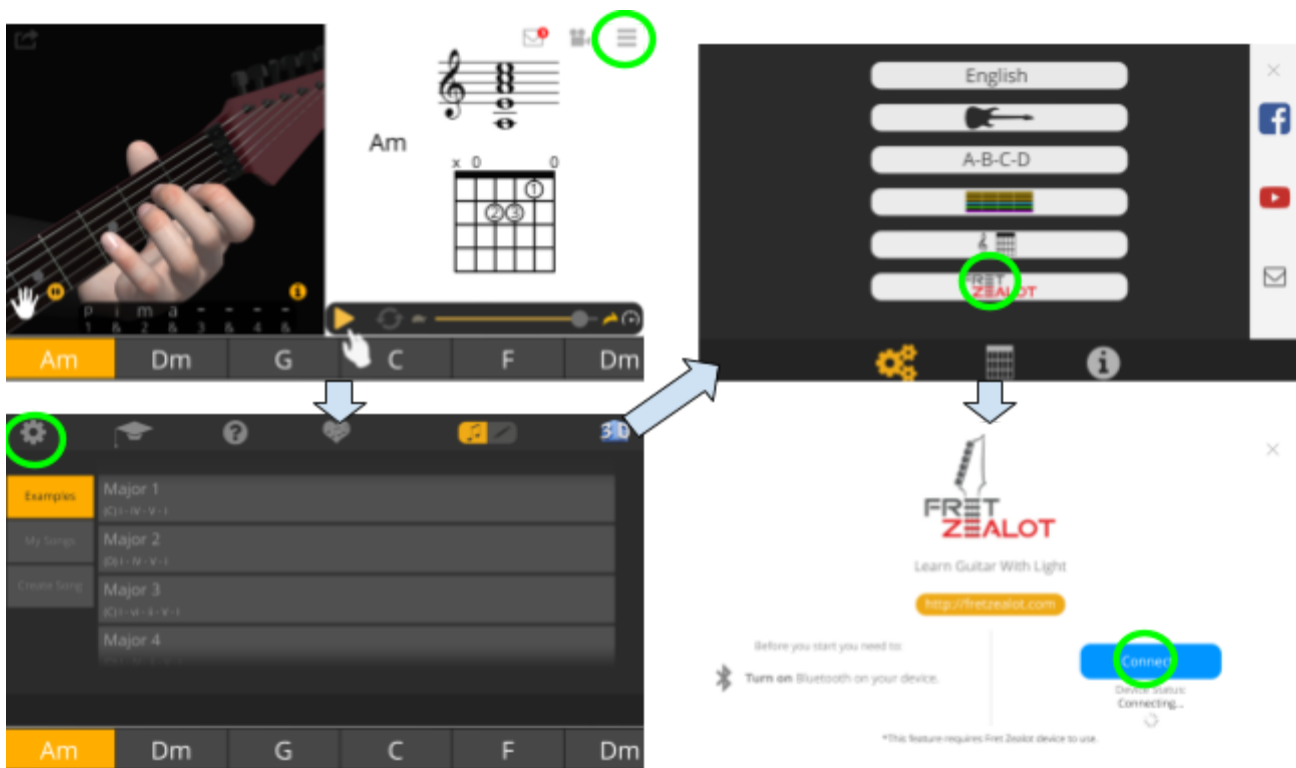

Updated October 16, 2019

Guitar 3D - Basic Chords is an app produced by Polygonium for [iOS](#) and [Android](#) devices. It is compatible with Fret Zealot for displaying individual chords, chord progressions, and song composition.



In the Guitar 3D app, press the '---' icon in the top right. From this screen, click the 'settings' gear in the top left.

At the settings screen, you will see a Fret Zealot button, press into this. Finally, here you will see the current status of the Fret Zealot connection. If no Fret Zealot is connected, you will be prompted with a blue 'Connect' button. Turn on your Fret Zealot, and press connect. This screen will then show you the connection status of your Fret Zealot.

